

Transmission & Distribution
Material & Installation Specification

600 Amp Deadbreak Elbow System

I. Quantity

The base bid shall include the indicated number of 600A, "Deadbreak Elbow System" and appropriate accessories included but not limited to silicon lubricant, grounding kits, mounting brackets, straps, assembly tools, testers, torque devices, cable adapters, abrasives, cleaners, and all necessary items for complete and operational Stick Operated Connector System.

II. Material

- A. The material shall be equal in quality, design, performance, and appearance to the items specified on drawing TDMIS-1103. All components shall be Elastimold or engineer approved equal.
- B. All steel hardware to be 302 Stainless Steel.
- C. Deadbreak Elbow body shall be a molded rubber or epoxy housing with semi-conductive outer coating compatible with 600A apparatus bushings. Connector system shall be rated for operation at 600 Amps continuous at 15KV Grnd Y / 8.3KV.
- D. Cable adapters and conductor connectors shall be provided and coordinated with the specific cable involved.

III. Installation

- A. The installation shall be as appropriate on drawing TDMIS-1103 as related to and called out on TDMIS unit assembly drawings or as needed to complete the circuit or circuit extension and/or circuit taps.
- B. Size and type hardware shall not be substituted without express approval of engineer.

- C. Only qualified personnel with at least 5 years' experience with high voltage terminations or certificate from a certified training school as approved by COC-DOP may be assigned to terminate MV cables. A resume of personnel's experience shall be submitted to DOP for approval 30 days prior to beginning terminations.
- D. Cables and cable accessories shall be kept clean and dry at all times during termination process. Suitable tents and heaters shall be employed as needed. Person performing cable termination shall clean hands frequently with MEK or other approved solvent to assure semi-conductive materials are not transferred from component to component.
- E. Silicone lubricants shall be applied liberally to separable components. It is recommended that additional tubes of lubricant be on hand as kits are not furnished with adequate lubricant.
- F. Connector components shall be cleaned and prepped according to the connector manufactures directions.
- G. Connectors components shall be considered complete when in final position and energized at operating voltage.

IV. Method of measurement

Shall be included with the unit for each ground mounted equipment or apparatus assembly requiring same and shall include all materials, accessories, lubricants, abrasives, adapters, tools, labor, equipment, and supervision required for a complete and operational module.

V. Basis of payment

Shall be included with the unit price for associated ground mounted equipment or apparatus.

CITY OF COLUMBUS DEPT. OF PUBLIC UTILITIES – DIVISION OF POWER 600 AMP DEADBREAK ELBOW SYSTEM		
DRAWN BY: AEC	DATE: 01/01/2018	TDMIS-1103
APPROVED: <i>[Signature]</i>		
	SHEET 1 of 2	

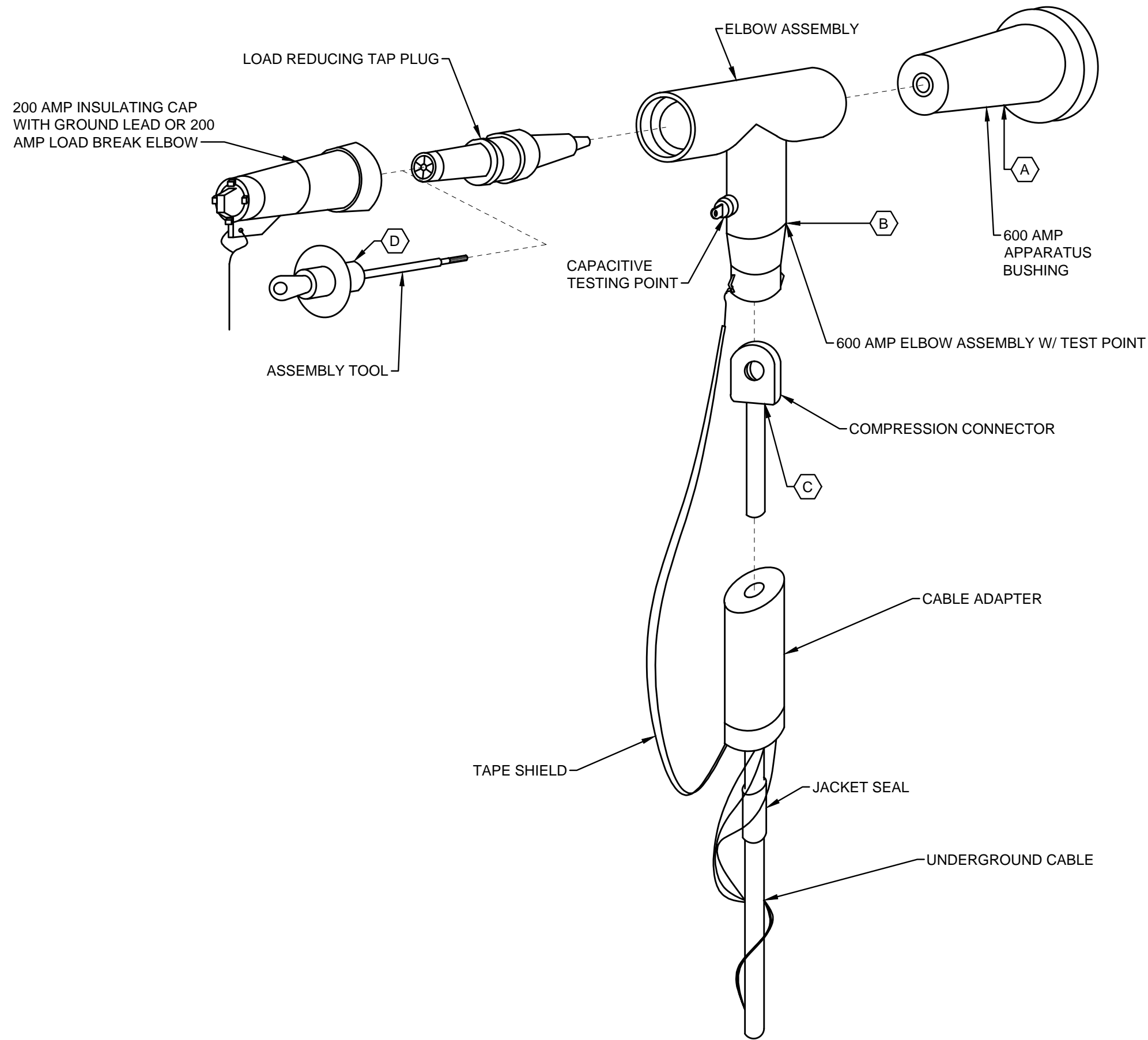

CODED NOTES:

- (A) REMOVE STUD IF PRESENT.
- (B) ELBOW ASSEMBLY CONTAINS THE 600 AMP ELBOW, LOAD REDUCING TAP PLUG AND INSULATING CAP.
- (C) CONNECTOR ASSEMBLY CONTAINS THE COMPRESSION CONNECTOR, CABLE ADAPTER AND JACKET SEAL.
- (D) ASSEMBLY TOOL AND TEST TOOL ARE REQUIRED TO INSTALL AND OPERATE THIS SYSTEM. (NOT INCLUDED WITH DEADBREAK ELBOW SYSTEM).

**DETAIL 1
DEADBREAK ELBOW SYSTEM**

CITY OF COLUMBUS, OHIO DEPT. OF PUBLIC UTILITIES - DIVISION OF POWER	
600 AMP DEADBREAK ELBOW SYSTEM	
DRAWN BY: AEC	DATE: 01/01/2018
APPROVED: <i>[Signature]</i>	TDMIS-1103
SCALE: NTS	