

UTILITIES

UTILITIES KNOWN TO BE LOCATED WITHIN THE LIMITS OF THIS PROJECT ARE LISTED BELOW WITH CONTACT INFORMATION.

AEP OHIO
700 MORRISON RD
GAHANNA, OH 43230
PH: 614-883-6802
ATTN: BRENT GATES
ATTN: ROD SLONEKER

SPECTRUM
3760 INTERCHANGE RD
COLUMBUS, OH 43204
PH: 614-481-5047
CELL: 614-348-2966
ATTN: SAM LUTZ

AEP TRANSMISSION
700 MORRISON RD
GAHANNA, OH 43230
PH: 614-552-1893
ATTN: MIKE CARR

AT&T OHIO
111 N 4TH ST
COLUMBUS, OH 43215
PH: 614-223-7276
CELL: 740-532-9943
ATTN: CHARLES JOHNSON

COLUMBIA GAS OF OHIO
3550 JOHNNY APPLESEED CT
COLUMBUS, OH 43231
CELL: 614-370-1906
ATTN: ROB CALDWELL

COTA
33 N HIGH ST
8TH FLOOR, WILLIAM LHOTA BL
COLUMBUS, OH 43215

1-9 NOT USED

- 10 PID: 010-105300
JAMES-LIVINGSTON RETAIL, LLC
- 11 PID: 010-092271
KT COLUMBUS, LLC (22.68% INTEREST),
OG COLUMBUS, LLC (26.91% INTEREST),
RF COLUMBUS, LLC (18.00% INTEREST),
PB COLUMBUS, LLC (9.26% INTEREST),
JT COLUMBUS, LLC (6.945% INTEREST),
LT COLUMBUS, LLC (6.945% INTEREST),
DC COLUMBUS, LLC (9.26% INTEREST)
- 12 PID: 010-094837, 010-094836
ROBERT G. SCHMIDT, A.K.A. ROBERT G. SCHMIDT II
- 13 PID: 010-218917
DOLORES A. CORROVA, TRUSTEE OF THE DOLORES A.
CORROVA TRUST (½ INTEREST) AND JAMES M. CORROVA,
TRUSTEE OF THE JAMES M. CORROVA TRUST (½ INTEREST)
- 13A ROBERT COPPEL AND PAUL COPPEL
AKA ROBERT F. COPELL AND PAUL L. COPPEL
- 13B ROBERT COPPEL AND PAUL COPPEL
AKA ROBERT F. COPELL AND PAUL L. COPPEL
- 14 PID: 010-024750
COLUMBUS & SOUTHERN OHIO ELECTRIC CO.
- 15 PID: 010-093804
YOGESWARAN THAMYRAJAH AND
YOGESWAR YOGESWARAN
- 16 PID: 010-093806
YOGESWARAN THAMBYRAJAH
- 17 PID: 010-095783
COLUMBUS SOUTHERN POWER CO.
- 18 PID: 010-095782
EILEEN Y. CRENSHAW
- 19 PID: 010-093807, 010-093808, 010-093809, 010-093811
ROYAL JAMES PLAZA, LLC
- 20 PID: 010-095781
CHARLES K. SLAUGHTER SR. AND JUSTINE SLAUGHTER
- 21 PID: 010-095780
PATRICE MYERS
- 22 PID: 010-088332, 010-088296, 010-088309, 010-123457,
010-123458, 010-123459, 010-077442
BEXLEY COMMONS L.P.

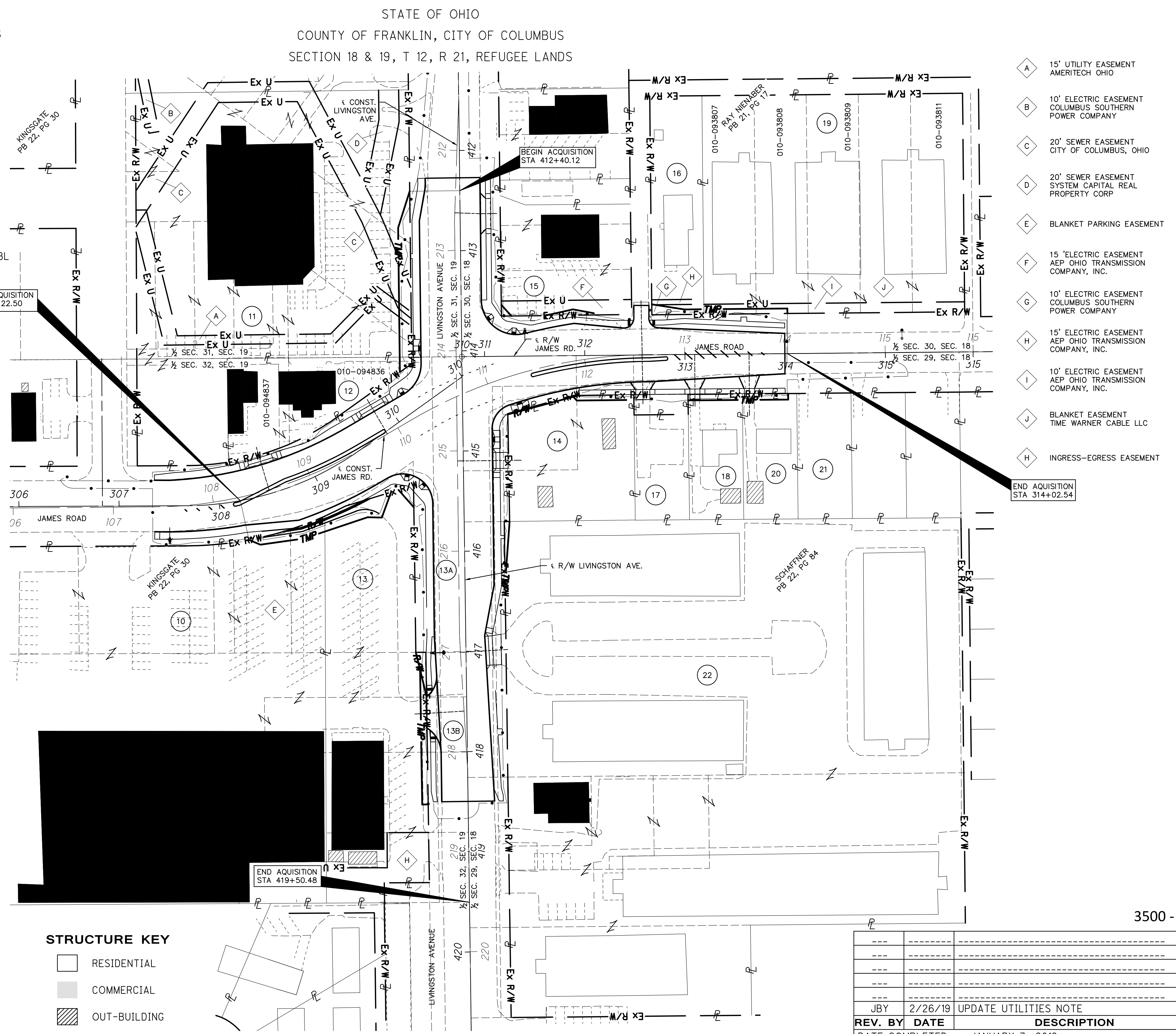

STRUCTURE KEY

- RESIDENTIAL
- COMMERCIAL
- OUT-BUILDING

- A 15' UTILITY EASEMENT AMERITECH OHIO
- B 10' ELECTRIC EASEMENT COLUMBUS SOUTHERN POWER COMPANY
- C 20' SEWER EASEMENT CITY OF COLUMBUS, OHIO
- D 20' SEWER EASEMENT SYSTEM CAPITAL REAL PROPERTY CORP
- E BLANKET PARKING EASEMENT
- F 15' ELECTRIC EASEMENT AEP OHIO TRANSMISSION COMPANY, INC.
- G 10' ELECTRIC EASEMENT COLUMBUS SOUTHERN POWER COMPANY
- H 15' ELECTRIC EASEMENT AEP OHIO TRANSMISSION COMPANY, INC.
- I 10' ELECTRIC EASEMENT AEP OHIO TRANSMISSION COMPANY, INC.
- J BLANKET EASEMENT TIME WARNER CABLE LLC
- H INGRESS-EGRESS EASEMENT

REV. BY	DATE	DESCRIPTION		
JBY	2/26/19	UPDATE UTILITIES NOTE		
DATE COMPLETED	JANUARY 3, 2019			

100
50
25
HORIZONTAL SCALE IN FEET

CALCULATED
CHECKED

PID NO. **101787**

PROPERTY MAP

JAMES RD AT LIVINGSTON AVE

3 / 13

122
132