



HORIZ SCALE



CALCULATED

CHECKED

MAINTENANCE OF TRAFFIC

PROJECT NAME



DRUMS WITH STEADY BURN LIGHTS
TYPICAL SPACINGS :-
8' RADI
25' TAPERS AND TANGENTS

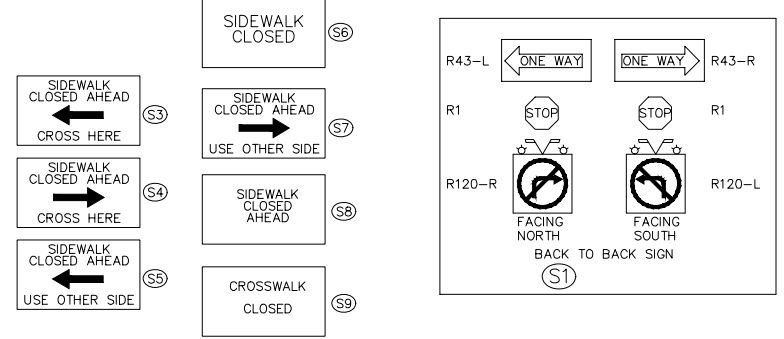
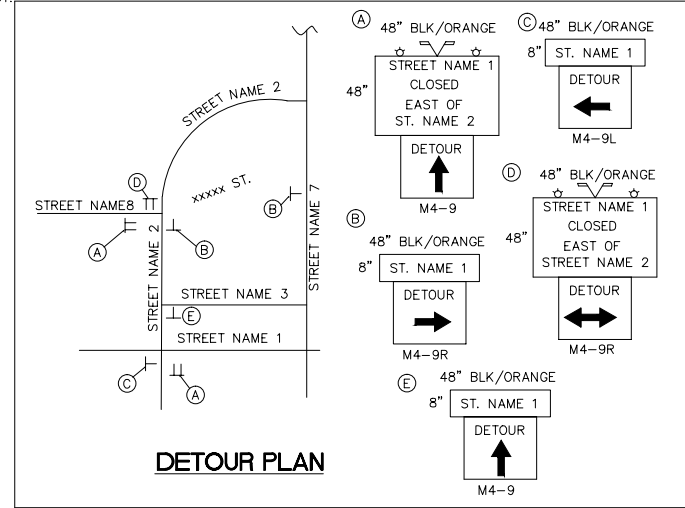
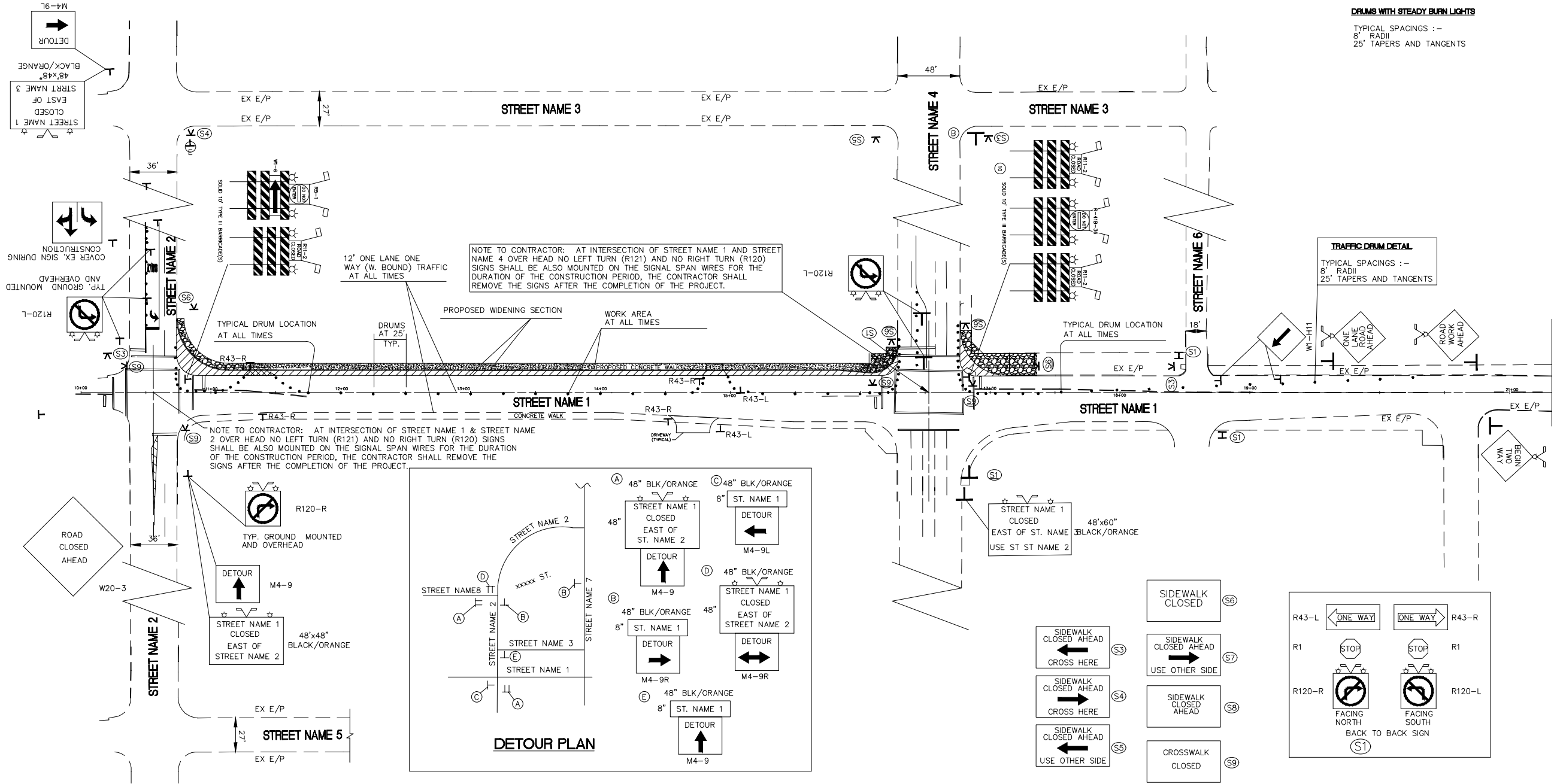

SIGNAL MOT
PHASE I
DURING PHASE I EASTBOUND SIGNAL HEADS FOR STREET NAME 11 @ STREET NAME 4 SHALL BE COVERED AND HAVE POWER DISCONNECTED TO THE HEADS AT THE CONTROL CABINET. (SEE ITEM 632 COVERING OF VEHICULAR/PED SIGNAL HEADS AND PUSHBUTTONS, AS PER PLAN SHEETS 31-46) CONTACT THE CITY OF COLUMBUS TRAFFIC MAINTENANCE SHOP AT 645-7933 WHEN SIGNAL HEADS ARE TO BE COVERED SO THE CITY CAN DISCONNECT THE EASTBOUND LOOP. (GIVE 3 CITY WORK DAY NOTICE) TEMPORARY SIGNAL POLE INSTALLATION WILL BE COMPLETED AT THIS TIME. EACH TEMPORARY SIGNAL POLE LOCATION IS TO BE STAKED AND THE LOCATION APPROVED BY THE TRANSPORTATION DIVISION SIGNAL INSPECTOR. THE CONTRACTOR MAY REUSE EXISTING SPAN OR INSTALL NEW AS REQUIRED BUT INSTALL TWO NEW PIGTAILS. AS PER PLAN, THE CONTRACTOR SHALL TRANSFER EXISTING SIGNAL ITEMS (SIGNAL CONTROLLER CABINET, PED UNITS, & PUSHBUTTONS W/SIGNS) AND EXTEND CABLE AS NEEDED. WEATHERPROOF SPLICING IS PERMITTED INCLUDING HEAD SHIFTING. ONE OR TWO DOWN GUYS ARE TO BE USED AS SPECIFIED.
PHASE II
SHIFT WESTBOUND SIGNAL HEADS AT STREET NAME1 @ STREET NAME 4 AND STREET NAME 1 @ STREET NAME 2. THE CONTRACTOR SHALL SHIFT OVERHEAD SIGNS AS INDICATED AND PLACE SIGNAL HEADS AT STREET NAME 1 @ STREET NAME 2 4' ON EACH SIDE OF THE CENTER LINE OF THE LANE. SIGNAL HEADS AT ROAD NO. 1 @ xxxx ST SHALL BE PLACED IN SAME MANNER UNLESS LEFT TURN LANE IS ADDED THEN SHIFT SIGNAL HEADS 1' FROM DOUBLE YELLOW LINE WITH 9' SPACING. THE CONTRACTOR SHALL NOTIFY THE SIGNAL MAINTENANCE SHOP (645-7933) THREE (3) CITY WORKDAYS PRIOR TO ANY LANE SHIFTING THAT EFFECTS TRAFFIC PASSING THROUGH A SIGNALIZED INTERSECTION OR PRIOR TO ANY SIGNAL WORK SO REQUIRED SIGNAL TIMING, PHASING OR CONTROL CABINET CHANGES CAN BE MADE TO THE EXISTING EQUIPMENT.

- CONSTRUCTION STAGING: STAGE 2**
CONSTRUCTION OF NEW PAVEMENT ON THE NORTH SIDE OF STREET NAME 1.
1. THE ERECTION OF THE TEMPORARY SIGNS AND TRAFFIC MARKINGS.
 2. THE CONSTRUCTION OF THE NEW WIDENING SECTION ON THE NORTH SIDE OF STREET NAME 1 AND THE CONSTRUCTION/RELOCATION OF ALL UNDERGROUND UTILITIES AND CONDUITS.
 3. THE FINAL PAVING OF THE ENTIRE PROJECT WIDTH AND LENGTH
 4. THE SEEDING AND MULCHING OF THE ENTIRE SITE.
 5. THE FINAL STRIPING AND SIGNING OF THE ENTIRE PROJECT
 6. THE CONSTRUCTION OF THE NEW SIGNAL AT THE INTERSECTION OF STREET NAME 1 AND STREET NAME 4, AND THE SIGNAL AT THE INTERSECTION OF STREET NAME 1 AND STREET NAME 2.
 7. THE CONTRACTOR SHALL PERFORM FINAL CLEANING AND REMOVE ALL EQUIPMENT FROM SITE
 8. THE CONTRACTOR SHALL COMPLY WITH THE FINAL PUNCH LIST PREPARED BY THE CITY'S INSPECTOR.
 9. THE CLOSE-OUT OF THE PROJECT.
 10. PAYMENT FOR MAINTENANCE OF TRAFFIC (NOT INCLUDING MOBILIZATION, PERMANENT SIGNING AND STRIPING) SHALL BE INCLUDED IN THE LUMP SUM ITEM 614 MAINTENANCE OF TRAFFIC.
 11. CONTRACTOR TO FURNISH AND INSTALL DRUMS TO CLOSE THE SOUTH BOUND LEFT LANE OF STREET NAME 4 AT ALL TIMES.

