

HORIZ. SCALE

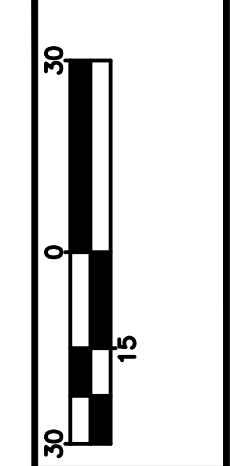

CALCULATED CHECKED

LIGHTING PLAN

PROJECT NAME

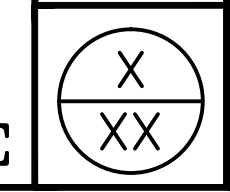

XXXX-E

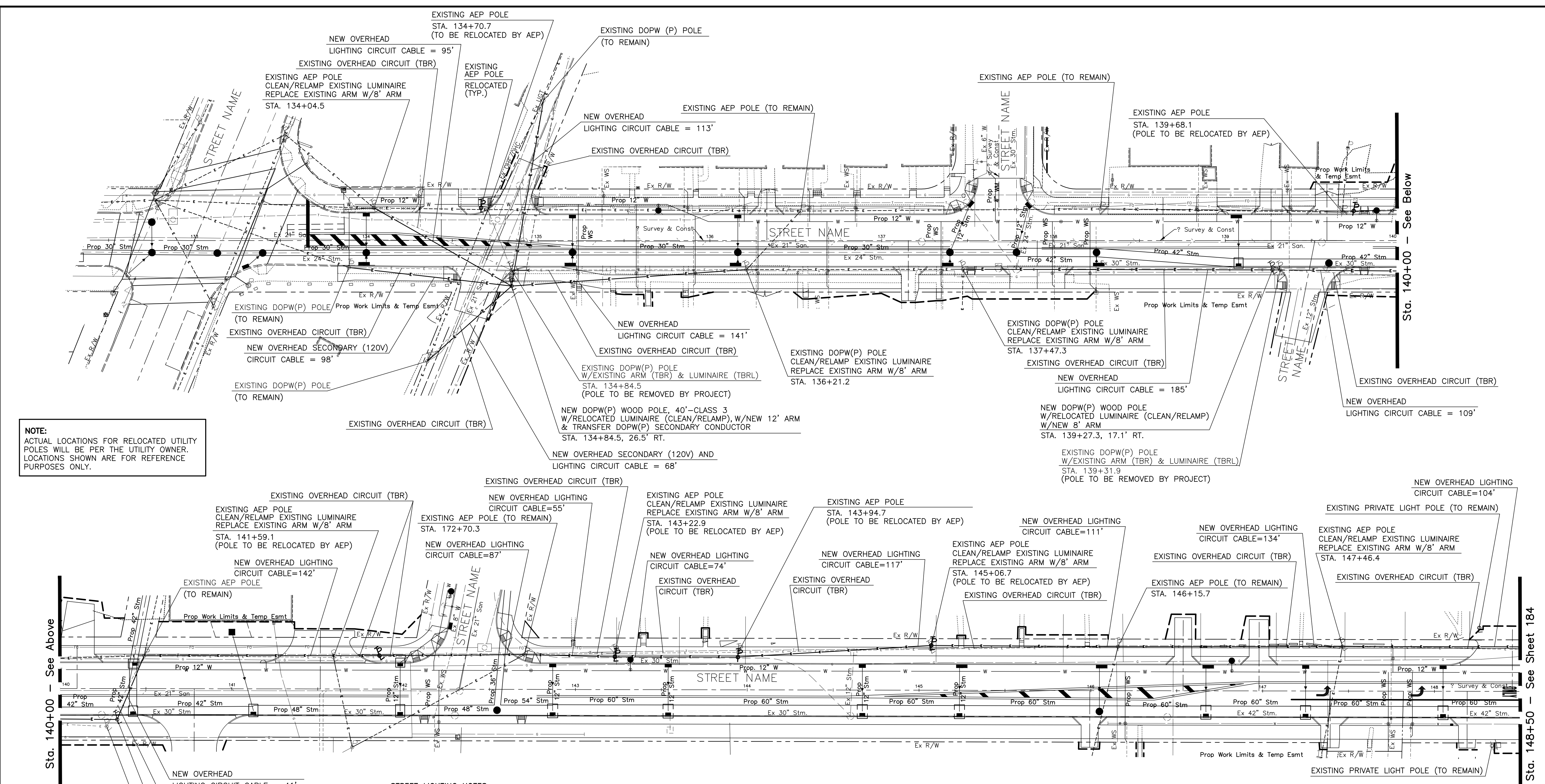

NOTE:
ACTUAL LOCATIONS FOR RELOCATED UTILITY POLES WILL BE PER THE UTILITY OWNER. LOCATIONS SHOWN ARE FOR REFERENCE PURPOSES ONLY.

EXISTING DOPW(P) POLE W/EXISTING ARM (TBR) & LUMINAIRE (TBRL) STA. 140+27.2 (POLE TO BE REMOVED BY PROJECT)

NEW DOPW(P) WOOD POLE W/RELOCATED LUMINAIRE (CLEAN/RELAMP) W/NEW 8' ARM STA. 140+33.3, 18.0' RT.

LEGEND

- Existing Overhead Circuit
- - - - - Proposed Overhead Circuit
- Other Overhead Electric or Communication
- ⊕ Pole W/Telephone, Power and Lighting
- AEP - American Electric Power
- DOPW(P) - Division Of Power And Water (Power)
- TBR - To Be Removed
- TBRL - To Be Relocated

STREET LIGHTING NOTES

The Street Lighting shall be constructed in accordance with the current City of Columbus, Ohio "Construction and Material Specifications"(CMS), (2002 Edition, Section 1000, titled "Street Lighting"), including all supplements thereto, in force on the date of the contract. CMS shall govern all materials and workmanship involved in the improvements shown on these plans, except as such specifications are modified by the following or by the specifications details set forth herein.

The plan details shall be considered supplemental to MIS Specifications.

The Contractor is responsible to comply with all Local codes and ordinances pertinent to the progression on the work described within the Project Plans. Any required permits shall be obtained and paid for by the Contractor. The Contractor and Sub-Contractor shall be responsible for complying with all Federal, State and Local safety requirements, together with exercising precautions at all times for the protection of persons (including employees) and property. It is also the sole responsibility of the Contractor and Sub-Contractor to initiate, maintain and supervise all safety requirements, precautions and programs in connection with the work.

Luminaires shall be relocated as shown in the drawings. All relocated luminaires shall be wired in accordance with MIS-10 and shall be cleaned and re-lamped in accordance with MIS-68. Bracket Arms (MIS-6 and MIS-10), overhead circuit cable (MIS-143), overhead circuit ground (MIS-26), down guy anchors (MIS-1) and wooden poles (MIS-42) as required shall be furnished at poles owned by the Division of Power and Water (Power).

Prior to the relocation process, the Contractor and the Engineer shall inspect the luminaires for the purpose of documenting any existing damage. Any dents or other damage identified after the luminaire has been relocated and not documented prior to the relocation operation will be presumed to have been caused by the Contractor. The Contractor shall be required to repair or replace the damaged luminaire at the option of the Design Engineer at the Contractor's expense.

Aerial cable replaced by new circuit cable shall be removed and disposed of by the Contractor per MIS-46.

DOPW(P) wood poles and hardware called out for removal herein, shall be removed and disposed of as per MIS-46.

As-Built Record - The Contractor shall maintain a set of project record documents. These documents shall include reviewed shop drawings, change orders, equipment operating instructions, field test records, and as-built drawings. The as-built drawings shall be marked legibly in red with the actual location of equipment as constructed.

All equipment installed shall have locations marked in distances off a landmark at least every 25 feet or location at a later date. Final documents and plans shall be handed over to the City of Columbus Division of Power and Water. The Division of Power and Water (Power) has overhead primary, secondary and overhead street lighting throughout the project area. The Contractor is hereby required to contact OUPS 1-800-362-2764 forty-eight hours prior to conducting any activity within the construction area. The DOPW (Power) dispatch office number is: (614) 645-7627 (voice).

All items of work called for on the plans, for which no specific method of payment is provided, shall be performed by the Contractor and the cost of these shall be included in the unit price bid for the various related items. This includes, but is not limited to, such incidental items as relocation of mail boxes, saw cutting, and removal and/or relocation of signs, railroad ties, sprinklers, relocating roof or sump drains around light pole foundations, hand digging around underground utilities or other miscellaneous items.

FOR THE DIVISION OF POWER AND WATER (POWER)

The Division of Power and Water (Power) has overhead primary, secondary and overhead street lighting throughout the project area bounded by Hudson St., Cleveland Ave., Joyce Ave., and Woodland Ave. The Contractor is hereby REQUIRED to contact OUPS 1-800-362-2764 forty-eight hours prior to conducting any activity within the construction area. The DOPW (Power) dispatch office number is: (614) 645-7627 (voice).

Any required relocation, support, protection, or any other activity concerned with the City's electrical facilities in the construction area is to be performed by the Contractor under the direction of Division of Power and Water (Power) (DOPW) personnel and at the expense of the project. DOPW shall make all final connections to DOPW's existing electrical system at the expense of the project. The Contractor shall use material and make repairs to the City of Columbus street lighting system by following the Division of Power and Water (Power)'s "Material and Installation Specifications" (MIS) and the City of Columbus "Construction and Material Specifications" (CMS). Any new or re-installed street light system shall require testing as referred to in section 1000.18 of the CMS manual. The Contractor shall conform to the Division of Power and Water (Power)'s existing Conductor Safety policy and Hold Card System (MIS-95), copies of which are available from the Division of Power and Water (Power).

If any electric facility belonging to the Division of Power and Water (Power) is damaged in any manner by the Contractor, its agents, servants, or employees, and requires emergency repairs, the Division of Power and Water (Power) shall make all necessary repairs, and the expense of such repairs and other related costs shall be paid by the Contractor to the Division of Power and Water (Power), City of Columbus, Ohio.

REVISED 12/2/11