

HORIZ. SCALE

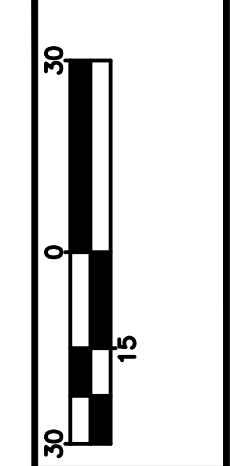

CALCULATED CHECKED

PROJECT NAME

LIGHTING PLAN

PROJECT NAME

PROJECT NAME

PROJECT NAME

XXXX-E

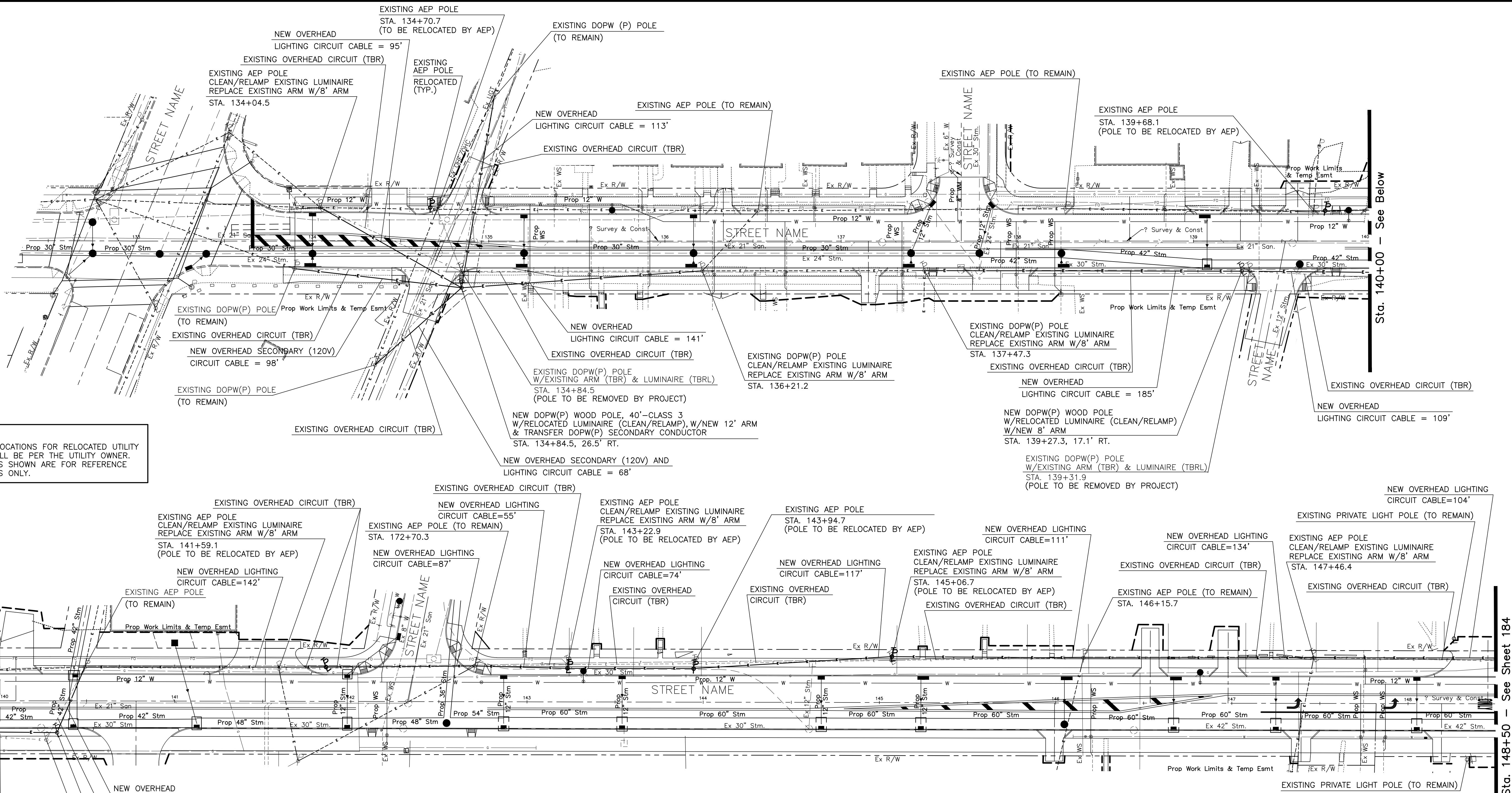

NOTE: ACTUAL LOCATIONS FOR RELOCATED UTILITY POLES WILL BE PER THE UTILITY OWNER. LOCATIONS SHOWN ARE FOR REFERENCE PURPOSES ONLY.

EXISTING DOPW(P) POLE W/EXISTING ARM (TBR) & LUMINAIRE (TBRL) STA. 140+27.2 (POLE TO BE REMOVED BY PROJECT)

NEW DOPW(P) WOOD POLE W/RELOCATED LUMINAIRE (CLEAN/RELAMP) W/NEW 8' ARM STA. 140+33.3, 18.0' RT.

LEGEND

- Existing Overhead Circuit
Proposed Overhead Circuit
Other Overhead Electric or Communication
Pole W/Telephone, Power and Lighting
AEP - American Electric Power
DOPW(P) - Division Of Power And Water (Power)
TBR - To Be Removed
TBRL - To Be Relocated

STREET LIGHTING NOTES

The Street Lighting shall be constructed in accordance with the current City of Columbus, Ohio "Construction and Material Specifications"(CMS), (2002 Edition, Section 1000, titled "Street Lighting"), including all supplements thereto, in force on the date of the contract.

The plan details shall be considered supplemental to MIS Specifications.

The Contractor is responsible to comply with all Local codes and ordinances pertinent to the progression on the work described within the Project Plans. Any required permits shall be obtained and paid for by the Contractor.

Luminaires shall be relocated as shown in the drawings. All relocated luminaires shall be wired in accordance with MIS-10 and shall be cleaned and re-lamped in accordance with MIS-68.

Prior to the relocation process, the Contractor and the Engineer shall inspect the luminaires for the purpose of documenting any existing damage.

Aerial cable replaced by new circuit cable shall be removed and disposed of by the Contractor per MIS-46.

DOPW(P) wood poles and hardware called out for removal herein, shall be removed and disposed of as per MIS-46.

As-Built Record - The Contractor shall maintain a set of project record documents. These documents shall include reviewed shop drawings, change orders, equipment operating instructions, field test records, and as-built drawings.

All equipment installed shall have locations marked in distances off a landmark at least every 25 feet or location at a later date. Final documents and plans shall be handed over to the City of Columbus Division of Power and Water.

All items of work called for on the plans, for which no specific method of payment is provided, shall be performed by the Contractor and the cost of these shall be included in the unit price bid for the various related items.

FOR THE DIVISION OF POWER AND WATER (POWER)

The Division of Power and Water (Power) has overhead primary, secondary and overhead street lighting throughout the project area bounded by Hudson St., Cleveland Ave., Joyce Ave., and Woodland Ave.

Any required relocation, support, protection, or any other activity concerned with the City's electrical facilities in the construction area is to be performed by the Contractor under the direction of Division of Power and Water (Power) (DOPW) personnel and at the expense of the project.

If any electric facility belonging to the Division of Power and Water (Power) is damaged in any manner by the Contractor, its agents, servants, or employees, and requires emergency repairs, the Division of Power and Water (Power) shall make all necessary repairs, and the expense of such repairs and other related costs shall be paid by the Contractor to the Division of Power and Water (Power), City of Columbus, Ohio.

REVISED 12/2/11