



590416-100004

CALCULATED
CHECKED

TITLE SHEET

NATIONWIDE BLVD SECURITY IMPROVEMENTS
NATIONWIDE BLVD-FROM 73' EAST OF JOHN H. McCONNELL BLVD TO 75' WEST OF
FRONT ST. & JOHN H. McCONNELL BLVD-FROM 65' NORTH OF NATIONWIDE BLVD TO
240' NORTH OF NATIONWIDE BLVD

1
68

CITY OF COLUMBUS, OHIO

DEPARTMENT OF PUBLIC SERVICE

DIVISION OF DESIGN AND CONSTRUCTION

IMPROVEMENTS OF NATIONWIDE BLVD & JOHN H McCONNELL BLVD

PROJECT DESCRIPTION

The purpose of this plan is to construct planters along the north and south side of Nationwide Boulevard from John H McConnell Boulevard to Front Street and construct new curb and planters along the east side of John H McConnell Boulevard from Nationwide Boulevard to a point 240' north of Nationwide Boulevard.

EARTH DISTURBED AREA

Total EDA = 0.273 Ac.
Pre-Impervious = 0.242 Ac.
Post-Impervious = 0.038 Ac.

2018 SPECIFICATIONS

The City of Columbus Construction and Materials Specifications (CMSC), 2018 Edition including all revisions and supplements thereto, shall govern all construction items that are a part of this plan unless noted otherwise.

CITY OF COLUMBUS APPROVALS

"City of Columbus" signatures on this plan signify only concurrence with the purpose and general location of the project. All technical details remain the responsibility of the Engineer preparing the plans.

	5/23/18
Design Section Engineer, Division of Design and Construction	Date
	6-4-18
Administrator, Division of Power	Date
	6-14-18
Administrator, Division of Sewerage and Drainage	Date
	5-29-18
Administrator, Division of Water	Date
	6-14-2018
Director, Department of Public Utilities	Date
	5-25-18
Fire Prevention Bureau, Division of Fire	Date
	5-25-18
Engineering Supervisor, Department of Technology	Date
	5-25-18
Director, Department of Recreation and Parks	Date
	6-14-18
City-Engineer-Administrator, Division of Design and Construction	Date
	6-18-18
Director, Department of Public Service	Date

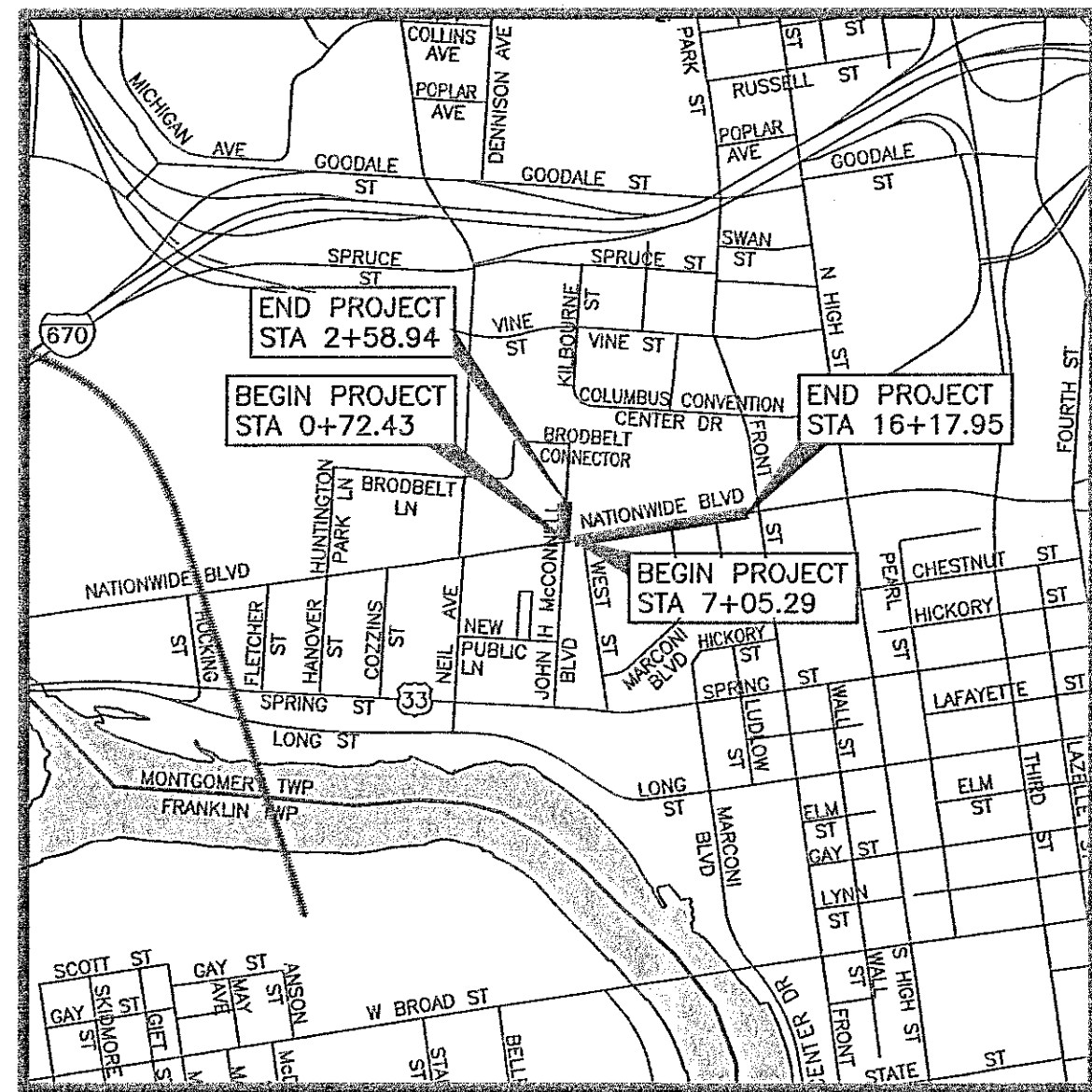

LOCATION MAP

P.O.B. = LATITUDE: 39°58'06" N LONGITUDE: 83°00'26" W

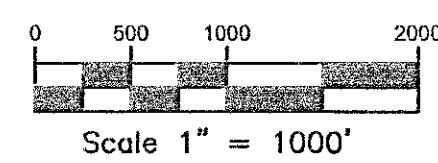

PORTIONS TO BE IMPROVED:

DESIGN DESIGNATION DATA

	Nationwide Blvd	John H. McConnell Blvd
Current ADT	9000	1400
Design Speed	25 mph	25 mph
Legal Speed	25 mph	25 mph
Classification	Urban Arterial	Urban Arterial

DESIGN EXCEPTIONS

None

FEMA NOTE

According to the Federal Emergency Management Agency's Flood Insurance Rate Map (dated 6/17/08), the subject parcel shown hereon lie within Zone "X", Community Panel No. 39049C0307K & 39049C0309K.

PREPARED BY:



ENGINEER

5-16-18
Date

Registered Engineer No.

NATIONWIDE BOULEVARD - FROM 73' EAST OF JOHN H. McCONNELL BLVD TO 75' WEST OF FRONT ST.
JOHN H. McCONNELL BLVD - FROM 65' NORTH OF NATIONWIDE BLVD TO 240' NORTH OF NATIONWIDE BLVD

INDEX OF SHEETS

Title Sheet	1
Schematic Plan	2-3
Typical Sections	4-5
General Notes	6-7
Maintenance of Traffic Notes	8
Maintenance of Traffic Plan	9-13
General Summary	14
Sedimentation & Erosion Control Notes & Post-Construction Storm Water Control Facilities	15
Sedimentation & Erosion Control Plan	16-17
Nationwide Blvd Plan View	18-19
John H. McConnell Blvd Plan View	20
Brick Removal Details	21-26
Concrete Walk Base Removal Details	27-32
Brick Walk and Concrete Base Install	33-38
Pavement Details	39-44
Water Quality Notes	45-46
Water Quality Plan, Profile and Details	47-48
Traffic Control Plan	49-51
Traffic Signal Notes & Plan	52-53
Lighting Plan	54
Landscaping Plan & Details	55-68

Sheet 22 Voided Sheet 22A Added

EXAMPLE REVISIONS

COLUMBUS STANDARD CONSTRUCTION DRAWINGS					
1441	12-01-14	2319	06-01-13		MIS-4
1500	09-15-15	2400	06-01-14		
1510	09-15-15	4000	08-10-17		
1550	09-15-15	4001	08-01-15		
2005	12-01-14	4021	08-10-17		
2179	06-01-13				
2195	06-01-13				
2300	06-01-14				
2301	06-01-14				
COLUMBUS SUPPLEMENTAL SPECIFICATIONS			ODOT STANDARD CONSTRUCTION DRAWINGS		
SS-1523	02-17-09		TC-41.20	MT-101.90	
SS-1630	11-13-09		TC-42.20	MT-105.10	
			TC-52.10	MT-110.10	
			TC-52.20		
			TC-71.10		
			MT-99.20		

REV NO	REVISION DESCRIPTION	SHEET(S)	INITIALS	DATE
1	Add clean outs on sanitary line, Voided sheet 22, added sheet 22A	1, 14, 22, 22A, 47		
2	Adjusted Planters, Qty's	1, 14, 55		



800-362-2764 or 8-1-1
www.oups.org

3458-E

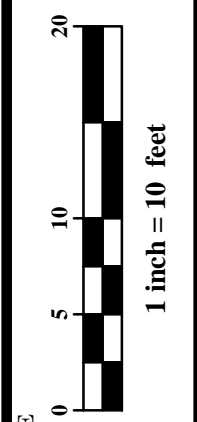
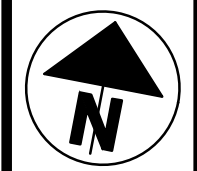

CALCULATED
JDU
CHECKED
SRS

BRICK SIDEWALK REMOVAL - NATIONWIDE BLVD

NATIONWIDE BLVD SECURITY IMPROVEMENTS
NATIONWIDE BLVD—FROM 73' EAST OF JOHN H. MCCONNELL BLVD TO 75' WEST OF
FRONT ST. & JOHN H. MCCONNELL BLVD—FROM 65' NORTH OF NATIONWIDE BLVD TO
240' NORTH OF NATIONWIDE BLVD

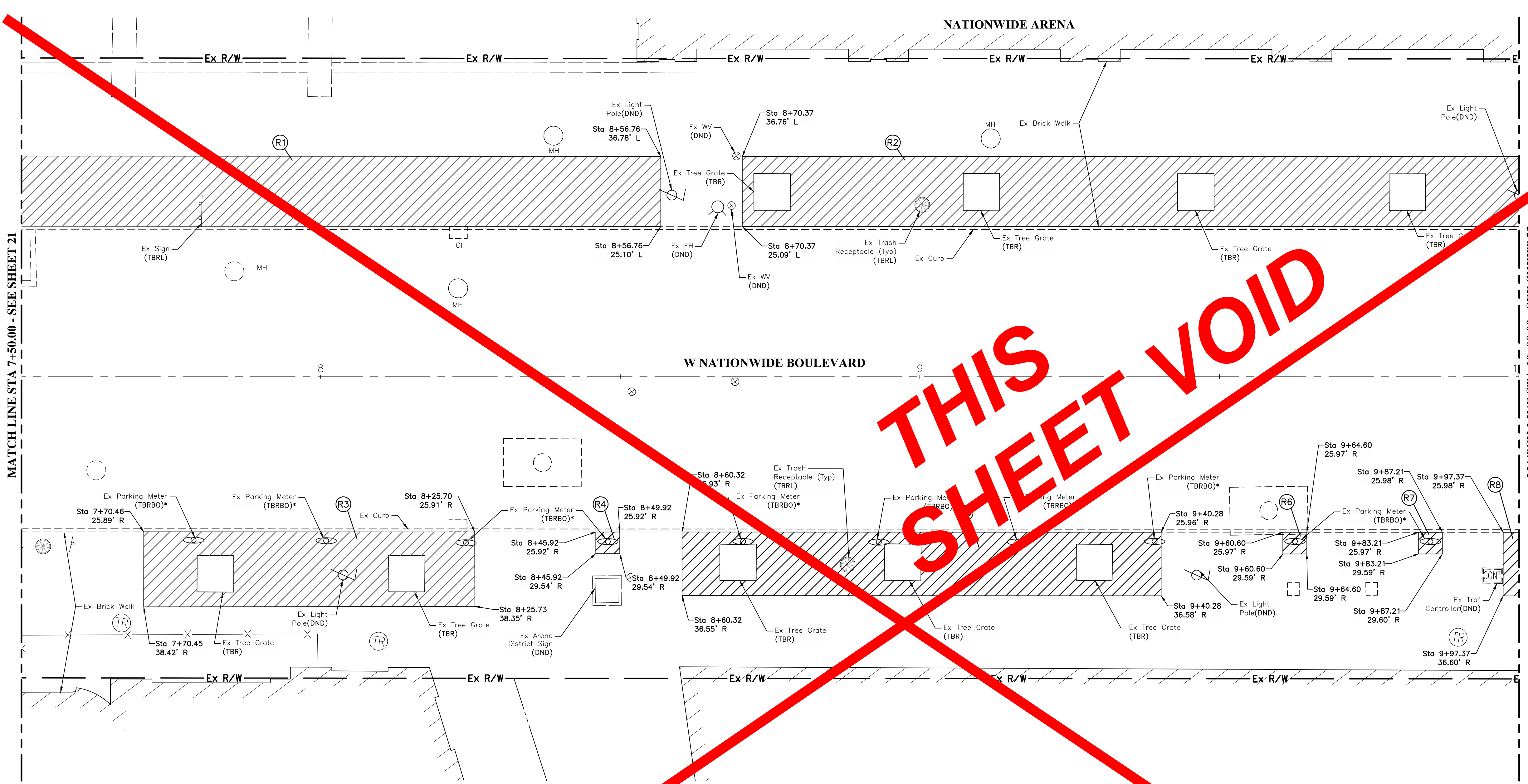

MATCHLINE STA 7+50.00 - SEE SHEET 21

MATCHLINE STA 10+00.00 - SEE SHEET 23

NATIONWIDE BLVD - 7+50 TO 10+00
SCALE: 1"=10'

LEGEND

Item 202. Brick Paver Walk Removed for Storage, As Per Plan

* Parking meters shown on this plan will be removed by the City of Columbus prior to the start of Construction.

REF NO	FROM	TO	SIDE	202	202	202
				SF	EA	EA
R1	7+50.00	8+56.76	LT	1249	-	-
R2	8+70.37	10+00.00	LT	1365	4	-
R3	7+70.45	8+25.73	RT	616	2	-
R4	8+45.92	8+49.92	RT	15	-	-
R5	8+60.32	9+40.28	RT	7	3	1
R6	9+60.60	9+64.60	RT	15	-	-
R7	9+83.21	9+87.21	RT	15	-	-
R8	9+97.37	10+00.00	RT	29	-	-
			TOTAL	4044	9	2

Note:
Any utility work, lowering of grade, paving, demolition, or other forms of earthwork in all areas within the drip line of trees including, but not limited to, the areas shown on these plans shall be accomplished as follows: Utilizing a trencher, cut an outline of the area to be modified to depth needed. After trenching use an air spade to remove soil from roots and provide a clean cut on roots with pruners. Use caution with heavy equipment during earthwork and demolition to minimize root disturbance. Contractor to contact the City Arborist prior to and during work for inspection where existing tree roots are encountered and for approval prior to backfilling trenches.

1 Sheet Voided

I:\2017\124\Drawings\04Sheets\public_e_plan\20171243-Brick Removal.dwg, Last Saved By: sstele, 5/18/2018 7:57 AM, Last Printed By: Steele, Sean, 5/18/2018 10:00 AM (No Xrefs)

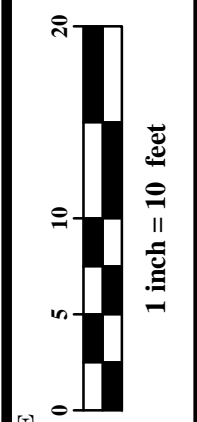
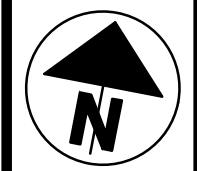

CALCULATED JDU
CHECKED SRS

BRICK SIDEWALK REMOVAL - NATIONWIDE BLVD

NATIONWIDE BLVD SECURITY IMPROVEMENTS
NATIONWIDE BLVD - FROM 73' EAST OF JOHN H. MCCONNELL BLVD TO 75' WEST OF NATIONWIDE BLVD - FROM 65' NORTH OF NATIONWIDE BLVD TO FRONT ST. & JOHN H. MCCONNELL BLVD - FROM 65' NORTH OF NATIONWIDE BLVD TO 240' NORTH OF NATIONWIDE BLVD

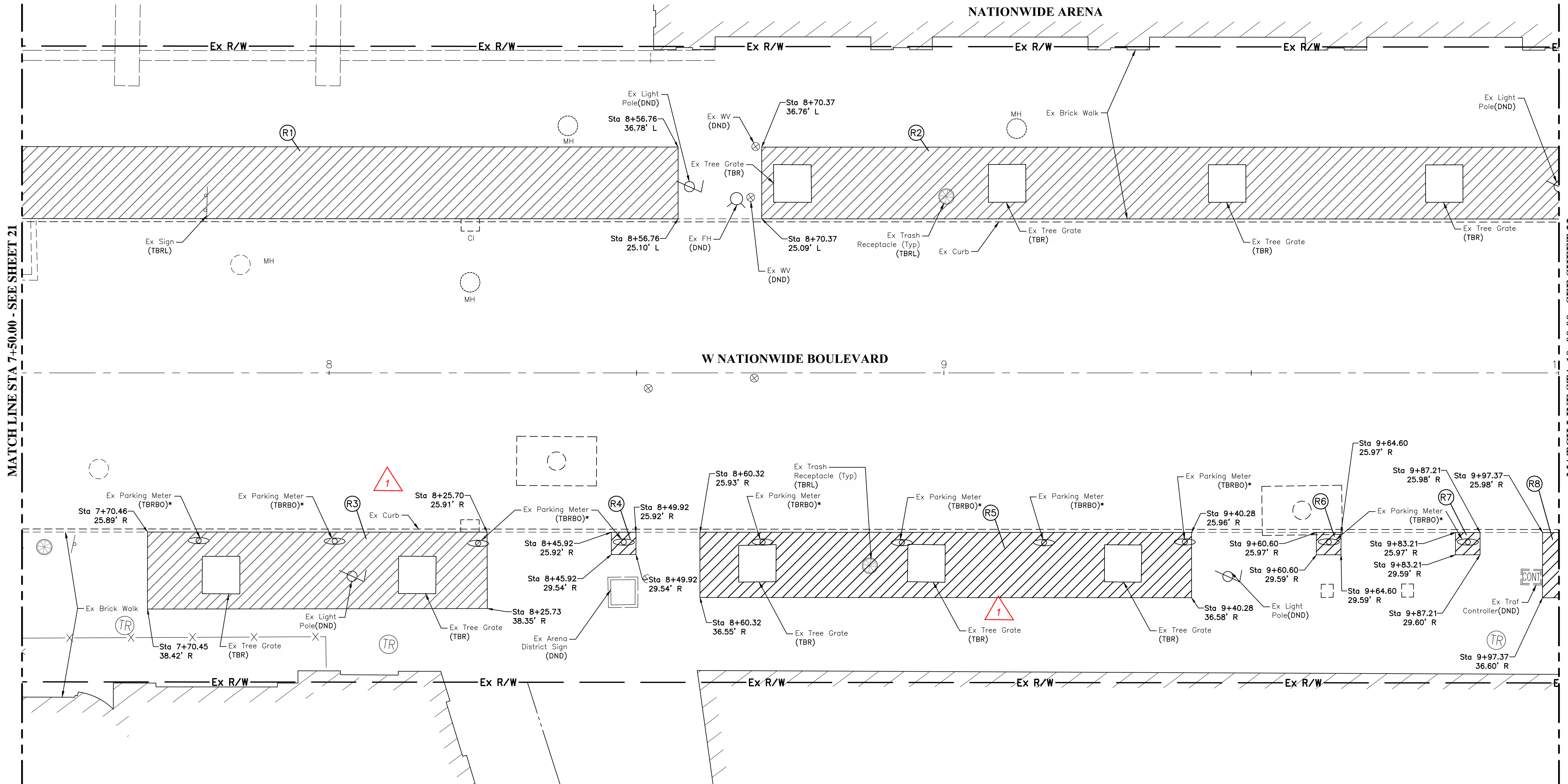

NATIONWIDE BLVD - 7+50 TO 10+00
SCALE: 1"=10'

LEGEND

 Item 202 - Brick Paver Walk Removed for Storage, As Per Plan

REF NO	FROM	TO	SIDE	202	202	202
				SF	EA	EA
R1	7+50.00	8+56.76	LT	1249	-	-
R2	8+70.37	10+00.00	LT	1365	4	1
R3	7+70.45	8+25.73	RT	616	2	-
R4	8+45.92	8+49.92	RT	15	-	-
R5	8+60.32	9+40.28	RT	740	3	1
R6	9+60.60	9+64.60	RT	15	-	-
R7	9+83.21	9+87.21	RT	15	-	-
R8	9+97.37	10+00.00	RT	29	-	-
			TOTAL	4044	9	2

* Parking meters shown on this plan will be removed by the City of Columbus prior to the start of Construction.

Note:
Any utility work, lowering of grade, paving, demolition, or other forms of earthwork in all areas within the drip line of trees including, but not limited to, the areas shown on these plans shall be accomplished as follows: Utilizing a trencher, cut an outline of the area to be modified to depth needed. After trenching use an air spade to remove soil from roots and provide a clean cut on roots with pruners. Use caution with heavy equipment during earthwork and demolition to minimize root disturbance. Contractor to contact the City Arborist prior to and during work for inspection where existing tree roots are encountered and for approval prior to backfilling trenches.

1 SHEET ADDED 4/8/19

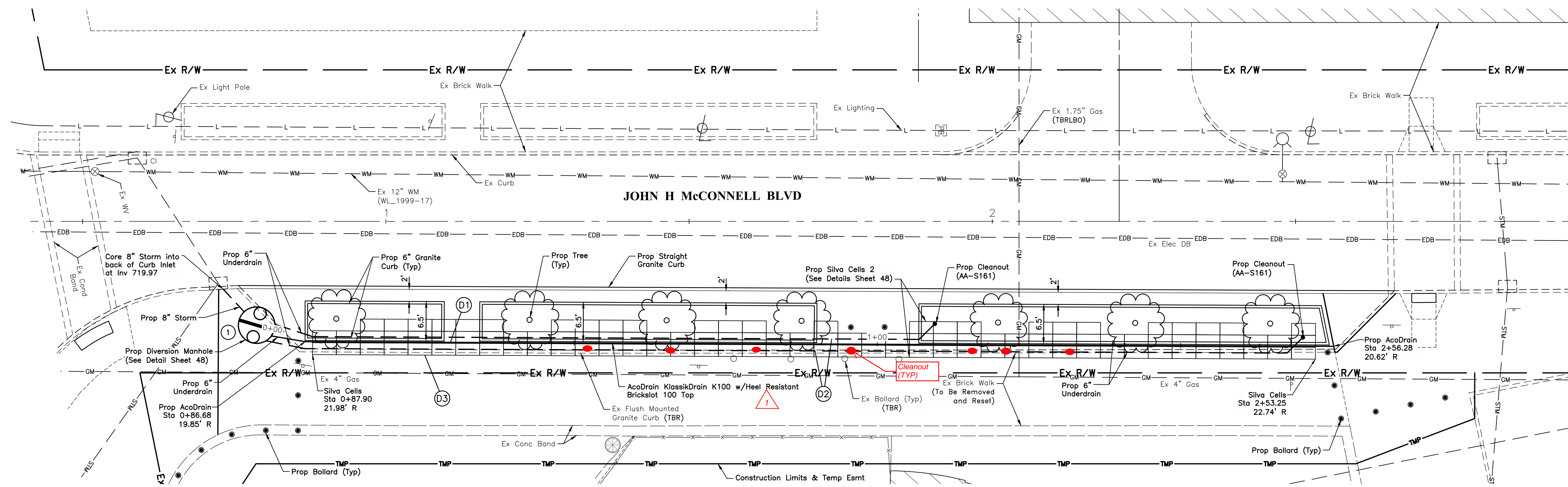

JOHN H. McCONNELL BLVD ACODRAIN & SILVA CELL DETAILS
SCALE: 1"=10'

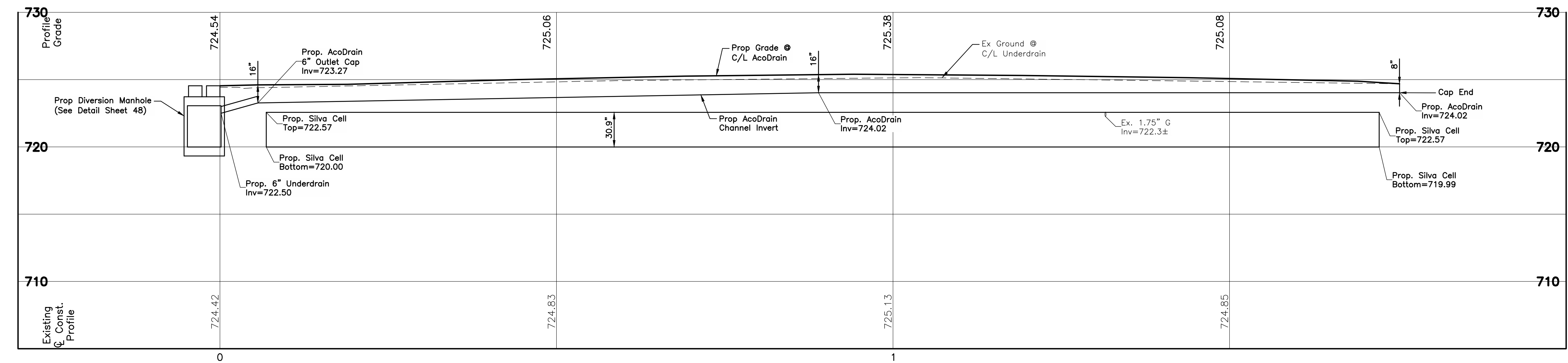

ACODRAIN & SILVA CELL PROFILE
SCALE: 1"=10' Horiz
1"=5' Vert

REF NO	FROM	TO	SIDE	605	605	605	901	915	SPEC	SPEC	SPEC	SPEC	SPEC
				LF	LF	LF	LF	Each	Each	SF	LF	Each	Each
D1	0+72.43	2+14.16	RT	-	-	-	6	-	1	-	170	1	1
D2	0+72.43	2+54.87	RT	166	104	19	-	-2.9	-	-	-	-	-
D3	0+87.90	2+53.25	RT	-	-	-	-	-	-	845	-	-	-
			TOTAL	166	104	19	6	-2.9	1	845	170	1	1

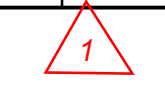

1 Added clean outs

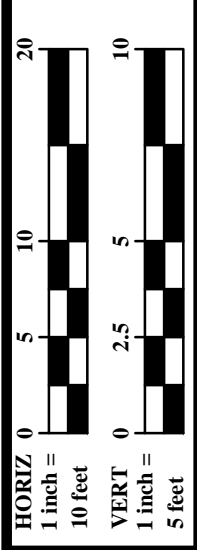

CALCULATED
CHECKED

WATER QUALITY PLAN, PROFILE AND DETAIL

NATIONWIDE BLVD SECURITY IMPROVEMENTS
NATIONWIDE BLVD-FROM 73' EAST OF JOHN H. McCONNELL BLVD TO 75' WEST OF
FRONT ST. & JOHN H. McCONNELL BLVD-FROM 65' NORTH OF NATIONWIDE BLVD TO
240' NORTH OF NATIONWIDE BLVD

ABBREVIATIONS

AB	ANCHOR BOLT	HP	HIGH POINT
AD	AREA DRAIN	HT	HEIGHT
ADA	AMERICANS WITH DISABILITIES ACT	ID	INSIDE DIAMETER
ADD	ADDENDUM	IDR	INLET DRAIN
ADJ	ADJACENT	IN	INCH, INCHES
AGG	AGGREGATE	INC	INCLUDED
ALT	ALTERNATE	INT	INTERIOR
AL	ALIGN	INV	INVERT
APPR	APPROXIMATE	JB	JUNCTION BOX
ARCH	ARCHITECT	L.O.W.	LIMIT OF WORK
AUTO	AUTOMATIC	LP	LOW POINT
AWA	ALIGN WITH ARCHITECTURE	LT	LIGHT FIXTURE
AWC	ALIGN WITH CENTER	MAX	MAXIMUM
B&B	BALLED AND BURLAPPED	MECH	MECHANICAL
BC	BACK OF CURB	ME	MATCH EXISTING
BEL	BELOW	MH	MANHOLE
BET	BETWEEN	MIN	MINIMUM
BIT	BITUMINOUS	MISC	MISCELLANEOUS
BLDG	BUILDING	MS	MULTI-STEM
BLK	BLOCK	NIC	NOT IN CONTRACT
BOT	BOTTOM	NOM	NOMINAL
BR	BARE ROOT	NTS	NOT TO SCALE
BRK	BRICK	OA	OVERALL
BS	BOTH SIDES	OC	ON CENTER
BTC	BOTTOM OF CURB	OD	OUTSIDE DIAMETER
BTF	BOTTOM OF FOOTING	PCC	PRECAST CONCRETE
BTS	BOTTOM OF STEPS	PERF	PERFORATED
BTW	BOTTOM OF WALL	PERP	PERPENDICULAR
BVL	BEVEL	PIP	POURED IN PLACE
BW	BACK OF WALL	PLT	PLANTING AREA
BYND	BEYOND	PLUM	PLUMBING
CAL	CALIPER	POB	POINT OF BEGINNING
CB	CATCH BASIN	PP	PEAT POTS
CH	CHAMFER	PPP	PLANTS PER POT
CIP	CAST IN PLACE	PROP	PROPOSED
CJ	CONTROL JOINT	PRTR	PRESERVATIVE TREATED
CL	CENTER LINE	PT	POINT
CMU	CONCRETE MASONRY UNIT	PTP	PRESSURE TREATED PINE
CO	CLEANOUT	PW	POTABLE WATER
COL	COLUMN	PVMT	PAVEMENT
CONC	CONCRETE	QC	QUICK COUPLER
CONT	CONTINUOUS	QTY	QUANTITY
CRS	COURSE	R	RADIUS
CT	CLEAR TRUNK	RD	ROUND
CTR	CENTER	REINF	REINFORCED
DBH	DIAMETER AT BREAST HEIGHT	REM	REMOVE
DEM	DEMOLISH	REQD	REQUIRED
DIA	DIAMETER	REV	REVISION
DIM	DIMENSION	RIM	RIM ELEVATION
DS	DOWNSPOUT	R.O.W.	RIGHT OF WAY
DTL	DETAIL	SCH	SCHEDULE
DWG	DRAWING	SEC	SECTION
EA	EACH	SHT	SHEET
EJ	EXPANSION JOINT	SIM	SIMILAR
EL	ELEVATION	SNT	SEALANT
ELEC	ELECTRICAL	SPEC	SPECIFICATION
ENC	ENCLOSURE	SPR	SPREAD
ENG	ENGINEER	SS	STAINLESS STEEL
EOP	EDGE OF PAVEMENT	ST	SINGLE TRUNK
EQ	EQUAL	STD	STANDARD
EQUIP	EQUIPMENT	STRUC	STRUCTURAL
EW	EACH WAY	SQ	SQUARE
EX	EXISTING	TBD	TO BE DETERMINED
EXT	EXTERIOR	TC	TOP OF CURB
FB	FACE OF BUILDING	TCB	TOP OF COLUMN BASE
FC	FACE OF CURB	TCM	TOP OF COLUMN
FFE	FINISH FLOOR ELEVATION	TEMP	TEMPERATURE
FG	FINISH GRADE	TF	TOP OF FOOTING
FIN	FINISH	TS	TOP OF STAIRS
FW	FACE OF WALL	TW	TOP OF WALL
FT	FOOT, FEET	TYP	TYPICAL
FTG	FULL TO GROUND	UC	UNDER CUT
FTR	FUTURE	UNO	UNLESS NOTED OTHERWISE
GA	GAUGE	VERT	VERTICAL
GAL	GALLON	VIF	VERIFY IN FIELD
GALV	GALVANIZED	W/	WITH
GC	GENERAL CONTRACTOR	W/O	WITHOUT
GEN	GENERAL	WLA	WATER LEVEL AVERAGE
GRT	GRATE ELEVATION	WLS	WATER LEVEL STATIONARY
HB	HOSE BIB	WM	WIRE MESH
HC	HANDICAPPED	WP	WATERPROOFING
HORIZ	HORIZONTAL	WWF	WELDED WIRE FABRIC

GENERAL NOTES - OVERALL PLAN

- CONTRACTOR SHALL BE RESPONSIBLE FOR BECOMING FAMILIAR WITH DRAWINGS FOR ALL DIVISIONS OF WORK.
- CONTRACTOR SHALL FAMILIARIZE HIMSELF/HERSELF WITH THE PROJECT SITE PRIOR TO BIDDING THE WORK.
- THE BASE MAPPING/SURVEY WAS PROVIDED BY "EMH&T". CONTRACTOR SHALL FIELD VERIFY ALL EXISTING CONDITIONS AND REPORT ANY DISCREPANCIES TO THE OWNER'S REPRESENTATIVE PRIOR TO COMMENCING WITH WORK.
- CONTACT OHIO UTILITY PROTECTION SERVICE (OUPS) 1-800-382-2764 AND ALL LOCAL UTILITY SERVICES FOR UTILITY LOCATIONS PRIOR TO COMMENCING WITH WORK.
- CONTRACTOR SHALL OBTAIN ALL REQUIRED PERMITS PRIOR TO COMMENCING WITH WORK.
- THE CONTRACTOR SHALL COORDINATE ALL WORK AND BE RESPONSIBLE FOR ALL METHODS, MEANS, SEQUENCE AND PROCEDURES OF WORK.
- CONTRACTOR SHALL PROVIDE ALL NECESSARY SAFETY MEASURES DURING CONSTRUCTION OPERATIONS TO PROTECT THE PUBLIC ACCORDING TO ALL APPLICABLE CODES AND RECOGNIZED LOCAL PRACTICES.
- CONTRACTOR IS REQUIRED TO TAKE DUE PRECAUTIONARY MEASURES TO PROTECT THE UTILITY LINES SHOWN ON THE DRAWINGS AS WELL AS ANY DISCOVERED DURING THE CONSTRUCTION PROCESS.
- CONTRACTOR SHALL COORDINATE ACCESS AND STAGING AREAS WITH THE OWNER'S REPRESENTATIVE.
- THE LIMIT OF CONSTRUCTION LINE SHOWN DEFINES THE LIMITS OF WORK IN THIS CONTRACT. THERE MAY BE INSTANCES WHERE EROSION PROTECTION DEVICES AND UTILITY SYSTEMS EXTEND BEYOND THE PROJECT LIMITS LINE IN ORDER TO SUCCESSFULLY COMPLETE OPERATIONS AND/OR TIE INTO ADJACENT SYSTEMS.
- THE CONTRACTOR SHALL KEEP ALL DRAINAGE FACILITIES AFFECTED BY HIS CONSTRUCTION OPERATIONS CLEAN AND FULLY OPERATIONAL AT ALL TIMES.
- MAINTAIN ALL EXISTING EROSION AND SEDIMENT CONTROL MEASURES (SILT FENCE, ORANGE GEO FENCE AND/OR OTHER MEASURES) DURING CONSTRUCTION. PROVIDE ADDITIONAL MEASURES AS NECESSARY TO MINIMIZE ADVERSE IMPACTS TO THE ADJACENT WATER BODIES, SURFACES AND STORM SEWERS ACCORDING TO ALL APPLICABLE FEDERAL/STATE LAWS AND REGULATIONS.
- CONTRACTOR SHALL VERIFY EXISTING CONDITIONS PRIOR TO COMMENCING WITH WORK. NOTIFY OWNER'S REPRESENTATIVE OF ANY DISCREPANCY BETWEEN THE PLANS AND ACTUAL SITE CONDITIONS. NO WORK SHALL BE DONE IN AREAS WHERE SUCH DISCREPANCIES EXIST. THE CONTRACTOR SHALL ASSUME FULL RESPONSIBILITY FOR ALL NECESSARY REVISIONS DUE TO FAILURE TO GIVE SUCH NOTIFICATION.
- REPORT ALL EXISTING DAMAGE OF EXISTING SITE IMPROVEMENTS TO THE OWNER'S REPRESENTATIVE PRIOR TO BEGINNING WORK. CONTRACTOR SHALL BE RESPONSIBLE FOR ALL SUBSEQUENT DAMAGE.
- CONTRACTOR SHALL PROTECT, BY WHATEVER MEANS NECESSARY, THE EXISTING SITE IMPROVEMENTS TO REMAIN. ALL DAMAGED ITEMS SHALL BE REPLACED OR REPAIRED AT NO ADDITIONAL COST TO THE OWNER. NOTIFY OWNER'S REPRESENTATIVE IMMEDIATELY IF ANY DAMAGE OCCURS.
- ALL AREAS WITHIN THE DRIPLINES OF EXISTING TREES SHALL REMAIN FREE OF CONSTRUCTION MATERIALS, DEBRIS, AND VEHICLES AT ALL TIMES. MINIMIZE FOOT TRAFFIC WITHIN TREE ROOT ZONES. NO WORK SHALL BE PERFORMED WITHIN THE DRIPLINE OF EXISTING TREES UNLESS INDICATED. ALL WORK, INCLUDING UTILITIES AND AIR-SPADING, INDICATED TO BE PERFORMED WITHIN THE DRIPLINE OF TREES SHALL BE DONE BY HAND AND CARE SHALL BE TAKEN TO MINIMIZE DISTURBANCE TO THE TREE ROOTS.
- CONTRACTORS SHALL COORDINATE ALL WORK WITH RELATED TRADES AND THE GENERAL CONSTRUCTION OF THE PROJECT SO AS NOT TO IMPEDE THE PROGRESS OF THE WORK OF OTHERS OR THE CONTRACTORS OWN WORK.
- EACH CONTRACTOR SHALL VERIFY THE CONDITION AND COMPLETENESS OF ALL WORK PERFORMED BY OTHERS IN RELATION TO HIS/HER PROJECT WORK RESPONSIBILITIES INCLUDING THE CHECKING OF EXISTING ELEVATIONS OR STRUCTURES PRIOR TO INITIATING CONSTRUCTION. THE CONTRACTOR SHALL IMMEDIATELY NOTIFY THE OWNER'S REPRESENTATIVE IF ANY SITE CONDITIONS ARE INCOMPLETE, MISSING OR DAMAGED.
- ALL CONSTRUCTION DEBRIS AND REMOVED ITEMS SHALL BE DISPOSED OF LEGALLY OFF-SITE UNLESS OTHERWISE INDICATED ON THE DRAWINGS.
- NOTIFY OWNER'S REPRESENTATIVE 72 HOURS IN ADVANCE OF ANY PLANNED UTILITY INTERRUPTION.
- CONTRACTOR SHALL CLEAN THE WORK AREAS AT THE END OF EACH WORKING DAY. ALL MATERIALS, PRODUCTS AND EQUIPMENT SHALL BE STORED IN AN ORGANIZED FASHION.
- CONTRACTOR SHALL EMPLOY SKILLED PERSONNEL AND USE EQUIPMENT NECESSARY TO ENSURE THAT ALL WORK IS PROFESSIONALLY AND PROPERLY INSTALLED AND IN FULL COMPLIANCE WITH THE PLANS AND DETAILS.
- CONTRACTOR SHALL COMPLY WITH STATE AND LOCAL LAWS AND REGULATIONS REGARDING NOTIFICATION OF EXISTING GAS AND OIL PIPELINE COMPANY OWNERS IF APPLICABLE. EVIDENCE OF SUCH NOTICE SHALL BE FURNISHED TO THE OWNER'S REPRESENTATIVE PRIOR TO COMMENCING WITH WORK.

22. CONTRACTOR SHALL EMPLOY SKILLED PERSONNEL AND USE EQUIPMENT NECESSARY TO ENSURE THAT ALL WORK IS PROFESSIONALLY AND PROPERLY INSTALLED AND IN FULL COMPLIANCE WITH THE PLANS AND DETAILS.

GENERAL NOTES - LAYOUT PLAN

- ALL DIMENSIONS SHOWN ARE IN FEET AND INCHES UNLESS OTHERWISE NOTED.
- ALL DIMENSIONS ARE TO THE EDGE OF PAVEMENT, FACE OF WALL, OR FACE OF CURB UNLESS OTHERWISE NOTED.
- ALL CONCRETE SCORING SHALL BE PARALLEL, PERPENDICULAR OR TANGENT TO ADJACENT IMPROVEMENTS UNLESS OTHERWISE NOTED. DO NOT SCALE DRAWINGS. UTILIZE DIMENSIONS INDICATED ON THE PLANS.
- PROVIDE ISOLATION JOINTS WHERE CONCRETE PAVING OR PAVING BASE MEETS A FIXED STRUCTURE (EXISTING AND PROPOSED).
- PROVIDE FLUSH CONDITIONS AT JUNCTURE OF ALL WALKWAYS.
- ALL FIELD STAKING & LAYOUT TO BE PERFORMED BY A REGISTERED SURVEYOR OR ENGINEER. THE OWNER'S REPRESENTATIVE WILL REVIEW THE LAYOUT FOR GENERAL CONFORMANCE PRIOR TO CONSTRUCTION.
- ALL WORK SHALL BE FURNISHED AND INSTALLED IN ACCORDANCE WITH THE PROVISIONS OF ALL APPLICABLE FEDERAL, STATE, LOCAL AND REGIONAL CODES, RULES, REGULATIONS AS INTERPRETED BY THE APPROPRIATE BUILDING DEPARTMENTS.
- ALL KNOWN EXISTING UTILITY LINES ARE NOTED ON THE DRAWINGS. THE CONTRACTOR SHALL BE SOLELY RESPONSIBLE TO PROTECT THEM DURING EXCAVATION. ANY DAMAGE TO UTILITIES AND ANY OTHER PROPERTY TO REMAIN SHALL BE REPAIRED IN KIND. IF CONTRACTOR ENCOUNTERS ANY UNFORESEEN UTILITY, HE SHALL BE RESPONSIBLE TO NOTIFY THE OWNER'S REPRESENTATIVE FOR FURTHER DIRECTION PRIOR TO PROCEEDING WITH THE WORK.
- THE PLANS ASSUME THAT THE LAYOUT AND STAKING WILL BE ACCOMPLISHED USING TOTAL STATIONING / DIGITAL METHODS. ANY INFORMATION PROVIDED ON THESE DRAWINGS IS INTENDED TO SUPPORT INFORMATION ALREADY CONTAINED IN CAD FILES USED FOR THE LAYOUT AND STAKING OF LANDSCAPE ELEMENTS. CAD FILES DELINEATING ALL GRADING AND HARDSCAPE ELEMENTS SHOWN IN THESE PLANS CAN BE PROVIDED TO THE CONTRACTOR UPON REQUEST.
- IN THE EVENT THAT DISCREPANCIES ARISE BETWEEN WHAT IS SHOWN ON THE DRAWINGS AND ACTUAL FIELD CONDITIONS THE ENGINEER OR LANDSCAPE ARCHITECT SHALL BE NOTIFIED IMMEDIATELY FOR RESOLUTION.

LANDSCAPE SUMMARY

NOTE: QUANTITIES ARE CARRIED TO THE GENERAL SUMMARY

ITEM	DESCRIPTION	QTY.	UNIT
605	UNDERDRAIN, 4" DIA. CORRUGATED POLYETHYLENE (PERFORATED), COMPLETE	139	Linear Feet
608	DETECTABLE WARNING, TYPE E, AS PER PLAN	184	Square Feet
653	TOPSOIL FURNISHED AND PLACED, AT PROPOSED TREE, (36" THICKNESS), AS PER PLAN	1,610	Square Feet
653	TOPSOIL FURNISHED AND PLACED, AT EXISTING TREE, (36" THICKNESS), AS PER PLAN	4,750	Square Feet
653	TOPSOIL FURNISHED AND PLACED, AT PLANTER WITH NO TREE, (18" THICKNESS), AS PER PLAN	130	Square Feet
661	DECIDUOUS TREE (4.5" CAL. - ACER RUBRUM 'AUTUMN BLAZE'), AS PER PLAN	7	Each
661	DECIDUOUS TREE (6" CAL. - PLATANUS X ACERFOLIA 'BLOODGOOD'), AS PER PLAN	6	Each
661	EVERGREEN SHRUBS (30" HT - TAXUS X MEDIA 'EVERLOW'), AS PER PLAN	1,144	Each
661	GROUNDCOVER (2" PEAT POT - HEDERA HELIX), AS PER PLAN	64,390-650/12	Each
SPEC	METAL EDGING AT EXISTING TREE, COMPLETE	40	Each
SPEC	EXISTING IRRIGATION SYSTEM MODIFICATION (HEADS, PIPING, VALVES, AND WIRING) COMPLETE	6,860	Square Feet
SPEC	IRRIGATION SYSTEM EXTENSION (HEADS, PIPING, VALVES, AND WIRING) COMPLETE	1,720	Square Feet
SPEC	IRRIGATION EXTENSION MAINLINE 2" PVC CLASS 200 SDR 21	263	Linear Feet
SPEC	IRRIGATION EXTENSION SLEEVING 4" PVC SCHEDULE 40	96	Linear Feet
SPEC	GRANITE BENCH	4	Each
SPEC	EMBEDDED METAL BOLLARD	29	Each
SPEC	REMOVABLE METAL BOLLARD	4	Each
SPEC	KIOSK FOOTER, COMPLETE	3	Each
SPEC	LITTER RECEPTACLE (STD DWG 2400)	1	Each

GENERAL NOTES - LANDSCAPE PLAN

- STAKE ALL BED LINES AND TREE LOCATIONS FOR THE LANDSCAPE ARCHITECT'S REVIEW PRIOR TO INSTALLATION. ALL PLANTING PROCEDURES ARE SUBJECT TO THE REVIEW OF THE LANDSCAPE ARCHITECT AND THE CONTRACTOR SHALL CORRECT ANY DEFICIENCIES FOUND AT NO ADDITIONAL COST TO THE OWNER.
- SECURE PLANT MATERIAL AS SPECIFIED ON PLANS. IN THE EVENT THAT PLANT MATERIALS SPECIFIED ARE NOT AVAILABLE, CONTACT LANDSCAPE ARCHITECT FOR SUGGESTED SUBSTITUTIONS. NO SUBSTITUTIONS FOR PLANT MATERIALS WILL BE ALLOWED WITHOUT PRIOR WRITTEN APPROVAL BY THE LANDSCAPE ARCHITECT.
- VERIFY THAT ALL PLANTING PRODUCTS, PLANT MATERIAL, AND PLANT QUANTITIES DELIVERED TO THE SITE MATCH WHAT IS INDICATED ON THE PLANS AND SPECIFICATIONS.
- PROTECT ALL PLANT MATERIAL DURING DELIVERY TO PREVENT DAMAGE TO ROOT BALLS, TRUNKS, BRANCHES AND THE DESICCATION OF LEAVES. PROTECT ALL PLANT MATERIAL DURING SHIPPING WITH SHADE CLOTH OR SHIP WITH ENCLOSED TRANSPORT. MAINTAIN PROTECTIONS AND HEALTH OF PLANT MATERIAL STORED ON SITE. HANDLE ALL TREES WITH NYLON STRAPS. NO CHAINS OR CABLES WILL BE ALLOWED. REMOVE UNACCEPTABLE PLANT MATERIAL IMMEDIATELY FROM THE SITE.
- ALL PLANT MATERIAL SHALL BE NURSERY GROWN, WELL FORMED, TRUE TO SPECIES, HARDENED OFF WITH VIGOROUS ROOT SYSTEMS, FULL CROWN AND CANOPIES, AND FREE FROM DISEASE, PESTS AND INSECTS, AND DEFECTS SUCH AS KNOTS, SUN SCALD, WINDBURN, LEAF DIS-COLORATION, IRREGULAR BRANCHING OR INJURIES.
- ALL ROOT BALLS SHALL CONFORM TO THE SIZE STANDARDS SET FORTH IN "AMERICAN STANDARDS FOR NURSERY STOCK".
- ALL PLANT MATERIAL DELIVERED TO THE SITE IS SUBJECT TO THE REVIEW OF THE LANDSCAPE ARCHITECT BEFORE, DURING AND AFTER INSTALLATION.
- PROVIDE PLANT SAMPLES OR PHOTOGRAPHS OF EACH PLANT SPECIFIED TO THE LANDSCAPE ARCHITECT FOR COMPLIANCE REVIEW PRIOR TO INSTALLATION.
- TEST FILL ALL TREE AND PLANTING PITS WITH WATER, PRIOR TO PLANTING, TO ASSURE PROPER SOIL PERCOLATION. PITS WHICH DO NOT ADEQUATELY DRAIN SHALL BE FURTHER EXCAVATED TO A DEPTH SUFFICIENT FOR DRAINAGE TO OCCUR AND/OR BACKFILLED WITH SUITABLE DRAINAGE GRAVEL. NO ALLOWANCES SHALL BE MADE FOR PLANT MATERIAL LOSS DUE TO IMPROPER DRAINAGE. CONTRACTOR SHALL REPLACE LOST PLANT MATERIAL WITH SAME SIZE AND SPECIES AT NO ADDITIONAL COST TO OWNER.
- ALL PLANT MATERIALS SHALL BE PLANTED IN A PROFESSIONAL MANNER TYPICAL TO THE INDUSTRY STANDARDS OF THE AREA TO ASSURE COMPLETE SURVIVABILITY OF ALL INSTALLED PLANT MATERIALS AS WELL AS TO PROVIDE AN AESTHETICALLY APPROVED PROJECT. CONTRACTOR SHALL REFER TO THE PLANTING DETAILS FOR MINIMUM SIZE AND WIDTH OF PLANTING PITS AND BEDS, GUYING AND STAKING, MULCHING, AND OTHER PLANTING REQUIREMENTS.
- ALL PLANTING AREAS SHALL BE WEED FREE PRIOR TO PLANTING INSTALLATION.
- REMOVE ALL PLANTING AND LANDSCAPE DEBRIS FROM THE PROJECT SITE DAILY AND SWEEP AND WASH CLEAN ALL PAVED AND FINISHED SURFACES AFFECTED BY THE LANDSCAPE INSTALLATION.
- REFER TO THE SPECIFICATIONS FOR MORE INFORMATION ON SOIL AMENDMENTS AND SOIL MIXES.
- MEASUREMENT SHALL BE BASED ON THE NUMBER OF SQUARE FOOT OF MATERIAL FURNISHED AND COMPACTED ON SITE PER THE DIRECTED DEPTH, INCLUDING EXCAVATION AND DISPOSAL OF IN-SITU SOILS. ANY ADDITIONAL SOIL NEEDED FOR COMPACTION SHALL BE INCLUDED IN THE SQUARE FOOT COST OF THE SOIL. THE CONTRACTOR IS RESPONSIBLE FOR DETERMINING TRUCK HAULING CONVERSION RATES BETWEEN LOOSE VERSUS COMPACTED MATERIAL. THE EXCAVATION AND DISPOSAL OF IN-SITU SOILS AS NECESSARY FOR THE PLACEMENT OF THE PROPOSED PLANTING SOILS SHALL BE INCLUDED WITHIN THE UNIT BID COSTS OF THE SOIL, AND HAS NOT BEEN SEPARATELY ITEMIZED.

CALCULATED
CHECKED

GENERAL NOTES

NATIONWIDE BLVD SECURITY IMPROVEMENTS
NATIONWIDE BLVD - FROM 73' EAST OF JOHN H. MCCONNELL BLVD TO 75' WEST OF FRONT ST. & JOHN H. MCCONNELL BLVD - FROM 65' NORTH OF NATIONWIDE BLVD TO 240' NORTH OF NATIONWIDE BLVD



2 REVISED QTY'S. DELETE NOTES

THE PROFESSIONAL LANDSCAPE ARCHITECT IS RESPONSIBLE FOR THE DESIGN INTENT FOR SHEETS 55 TO 66 WITHIN THIS PLAN SET.