

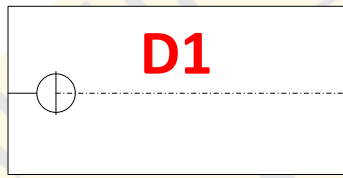



OIL AND LUBE MANUFACTURING

123 E MAIN ST

COL, OH 43123



LEGEND

-  Manual Fire Alarm Boxes
-  Exits
-  Fire Extinguishers
-  Fire Alarm Control Panel

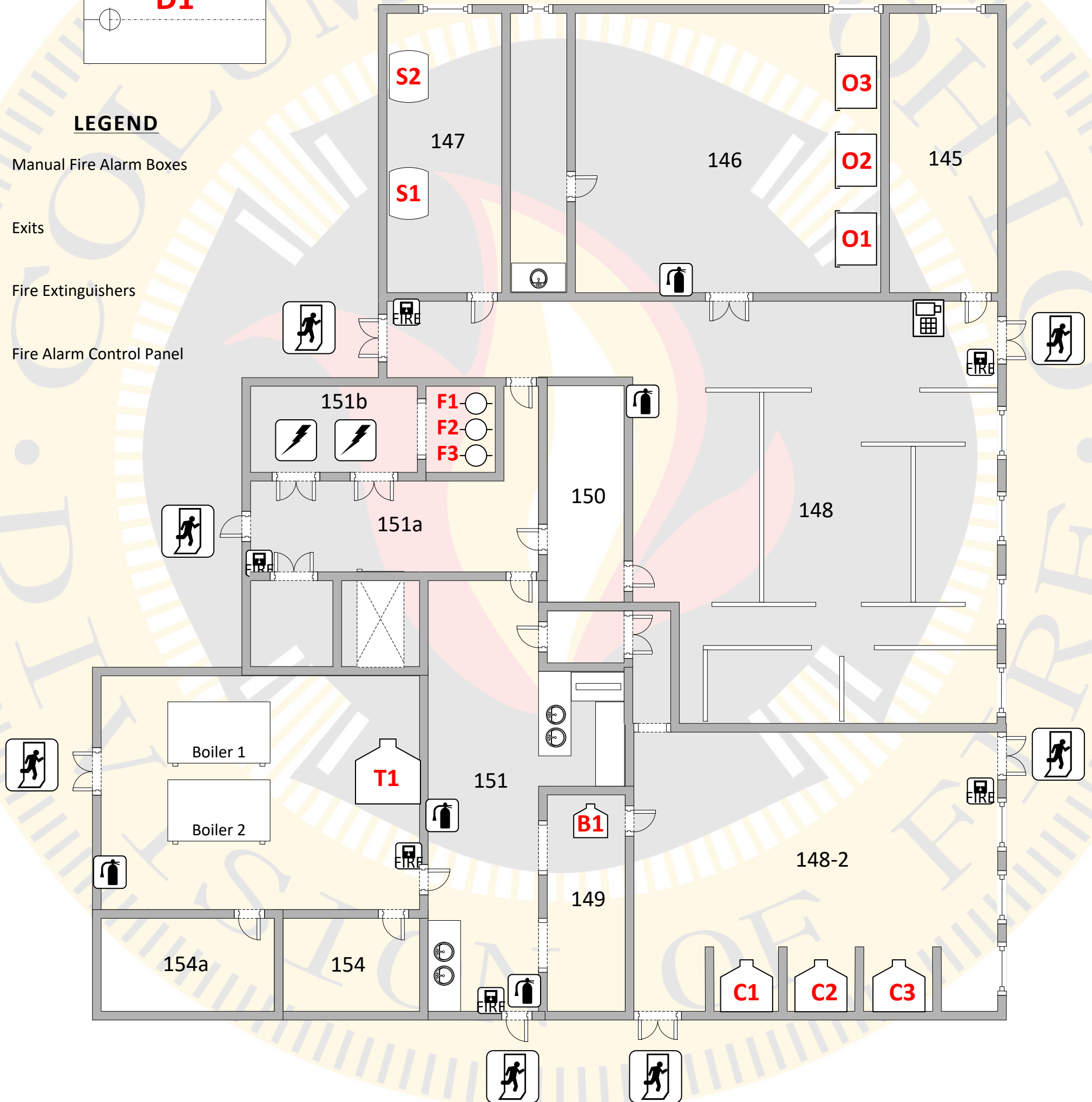

OIL AND LUBE MANUFACTURING
123 E MAIN ST
COL, OH 43123

HAZARDOUS MATERIALS INVENTORY STATEMENT (HMIS) INVENTORY REPORT
(Sort Products Alphabetically by Location of Product and then Alphabetically by Product Name)

Product Name (Components) ^c	CAS Number	Location ^a Tank	Container > 55 gal ^b	Haz Class 1	Haz Class 2	Haz Class 3	Stored (lbs)	Stored (gal)	Stored (gas) ^d	Closed (lbs)	Closed (gal)	Closed gas ^d	Open (lbs)	Open (gal)
ACETYLENE (Acetylene gas)	74-86-2	Rm 151b F1, F2, F3		FLG	UR2				150					
BLACK AEROSOL SPRAY PAINT (Mixture)	Mixture	Rm149 B1		A-L3			24							
GASOLINE, UNLEADED (Gasoline-Mixture) Methyl-t-Butyl-Ether-15% Diisopropyl Ether-7% Ethanol-11% Toluene-12% Xylene-11%	8006-61-9 1634-04-4 108-20-3 64-17-5 108-88-3 1330-20-7	Exterior NW- corner D1		F1B				5						
MOTOR OIL-10W40 (Hydrotreated Heavy Paraffinic Distillate-85%; Additives-20%)	64742-54-7 Mixture	Rm 147 S1, S2		C3B				3						
DIESEL (Diesel-99-100%; Additives)	68476-34-6 Proprietary	Rm 146 O1, O2, O3	Yes	C2				225						
TRANSMISSION FLUID (Oil-Solvent-Neutral; Performance Additives)	64742-65-0	Rm148-2 C1, C2, C3		C3B				3						
OXYGEN, GAS (Oxygen)	7782-44-7	Rm154b T1		OXG					5,000					

- a. Identify the control area or, if it is a Group H occupancy, provide the classification, such as H-2, H-3, etc.
- b. If the product container, vessel or tank could exceed 55 gallons, indicate yes in the column.
- c. Specify percentages of main components if available.
- d. In cubic feet, gallons or pounds.

(This is an example; add additional hazard classes as needed.)